



PLEASE READ THIS ENTIRE GUIDE BEFORE BEGINNING INSTALLATION.

Models LGMD, MDDM, and SMDM are certified for installation in single swing 20 minute rated wood solid-core or composite-core doors up to and including 36 in. (914 mm) in width by 80 in. (2032 mm) in height, no hose locations.

NOTE

We are using the term "door to the garage" this door has several meanings i.e., house to garage door, access door to the garage, people door to the garage, man door or pedestrian door.

FireSafe Pet Doors LLC door mounted fire rated pet doors can be installed in most residential solid wood and composite core 20-minute fire rated doors to the garage. Our doors are UL tested and certified to comply with Nation Fire Protection Agency fire codes. Your local building department may have amendments to the NFPA codes. Check with your local building department.

WARNING

It is especially important to know if your door to the garage is fire rated before making any modifications to the door. Certain products and door modifications compromise the door's ability to keep fire from passing through the fire rated door and cause the door to lose its fire rating.

We highly recommend contacting a professional to determine if your door to the garage meets local building codes before installing FireSafe pet doors.

Due to various styles and types of fire rated doors, there may be variations from different door manufacturers. Consult a professional as needed to ensure that the fire rated door to your garage meets local building and fire codes.

It is recommended that you hire a professional handyman, carpenter, licensed contractor, or professional installer to install FireSafe Pet Doors. However, our fire rated pet doors can be installed by a skilled "do it yourselfer" with good carpentry abilities.

If the FireSafe Pet Doors are installed in locations in the fire rated door to the garage other than as shown in the Installation Instructions herein, the user and installer assume all liability.

You may view our UL certification at <https://iq.ulprospector.com/en>

CAUTION

- Keep these instructions with important papers and be sure to transfer these instructions to any new owner of the property.
- When installing FireSafe pet door in the fire rated door to the garage, there should be a minimum of 3" between the bottom of the door and a minimum of 2 ½" from the side edge of the door to the cut-out area. This is required to maintain the fire rating and the structural integrity of the fire rated door.
- Use a manual screwdriver and wrench to tighten screws. Do not over tighten. Over tightening can strip the screws or warp the pet door frame.

TERMS OF USE AND LIMITATIONS OF LIABILITY

1. Terms of Use – This product is offered to you conditioned upon your acceptances and without modifications of the terms, conditions and notices contained herein. Installation use of the product creates acceptance of all such terms, conditions, and notices.
2. Proper Use – This product is designed for use in fire rated doors. Proper use includes reviewing the entire Installation Guide provided with your product including any specific safety information.
3. Limitations of Liability – In no event shall FireSafe Pet Doors LLC be liable for any direct indirect, punitive, incidental, special, or consequential damages whatsoever arising out of or connected with the use or misuse of this product. Buyer assumes all risks and liabilities from the use of this product.
4. Modifications of Terms and Conditions – FireSafe Pet Doors LLC reserves the right to change the terms, conditions, and notices under which this product is offered.
5. No Unlawful or Prohibited Use - This product is designed for use with pets only of an appropriate size for the door you have purchased and installed. The product is not intended to harm, injure or provide. Using this Product in a way this is not intended could result in a violation of Federal, State or local laws or ordinances.
6. Disabling Fire Rated Door - Consumer or end user shall not disable the firesafe pet door in any way including removing the door, sliding the door past the latch assembly pin. FireSafe Doors LLC shall not be responsible for the malfunction of the door if the door is not maintained properly.
7. Fusible Link - It recommended that you inspect the fusible link once a year by removing the latch assembly cover plate. It is recommended that you replace the fusible link every two years. Fusible links can be purchased online from FireSafe Pet Doors LLC. If you notice that door no longer rests on the pivot rod, you must replace your fusible link.



FireSafe Pet Doors Door Mount Installation Guide for Large Pet Door
PLEASE READ THIS ENTIRE GUIDE BEFORE BEGINNING



Model Number: LGDM (Large Fire Rated Pet Door)



WHATS INCLUDED

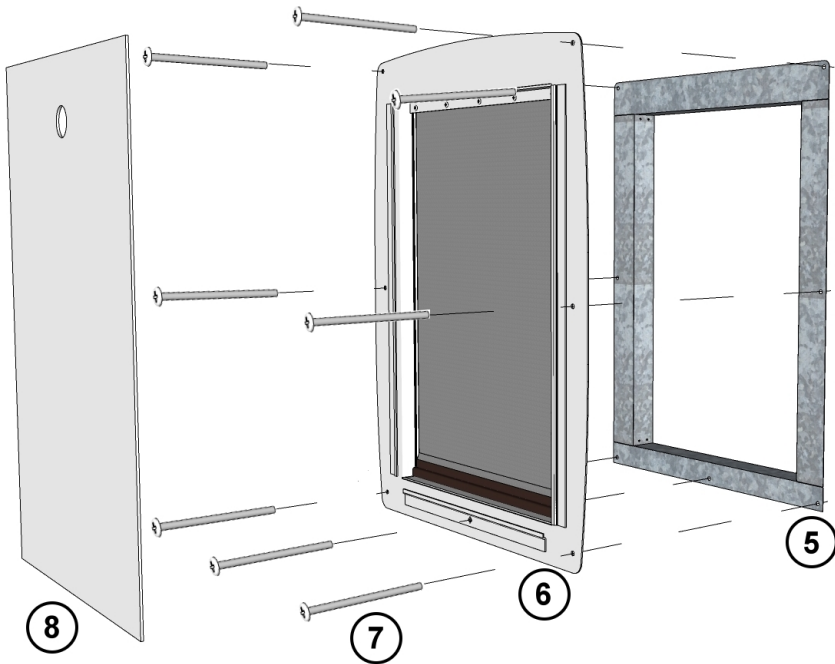

Interior Flap Frame & Sleeve

- ⑤ Door sleeve
- ⑥ Interior flap frame assembly
- ⑦ (7) #8 x 2 1/4" inch installation screws
- ⑧ PVC closure panel

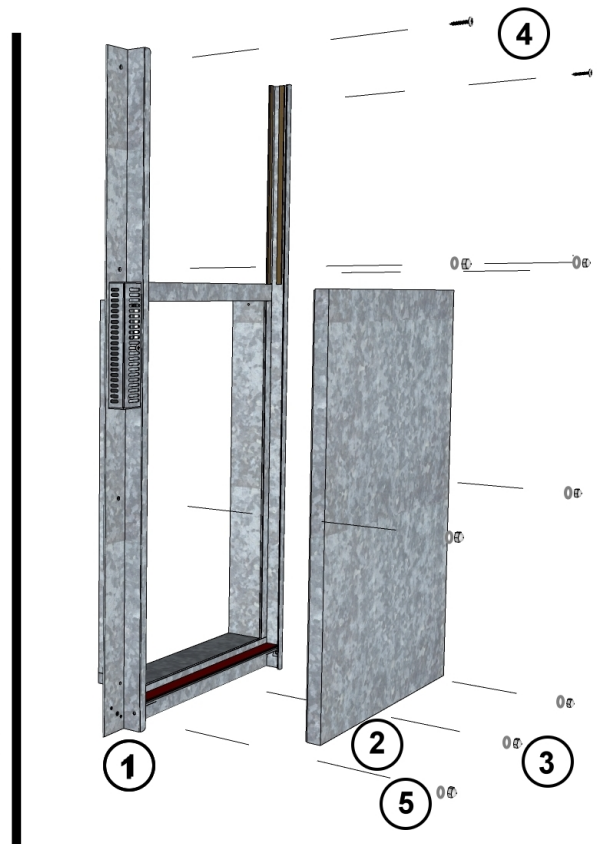

Garage Side Fire Rated Frame & Door

- ① Fire rated pet door frame assembly
- ② Fire rated door
- ③ (7) #8 Installation nuts
- ④ (2) #8 Wood screws (top of frame)
- ⑤ (7) Washers

INSTALLATION TOOLS NEEDED



NOTE Additional tools may be required (not shown)

Level
Drill
7/64" Drill bit
15/64" Drill bit
Measuring tape
Philips screw driver
Square
Pencil
Keyhole saw
Utility knife
Power saw
Wrench

INSTALLATION IN DIFFERENT DOOR STYLES

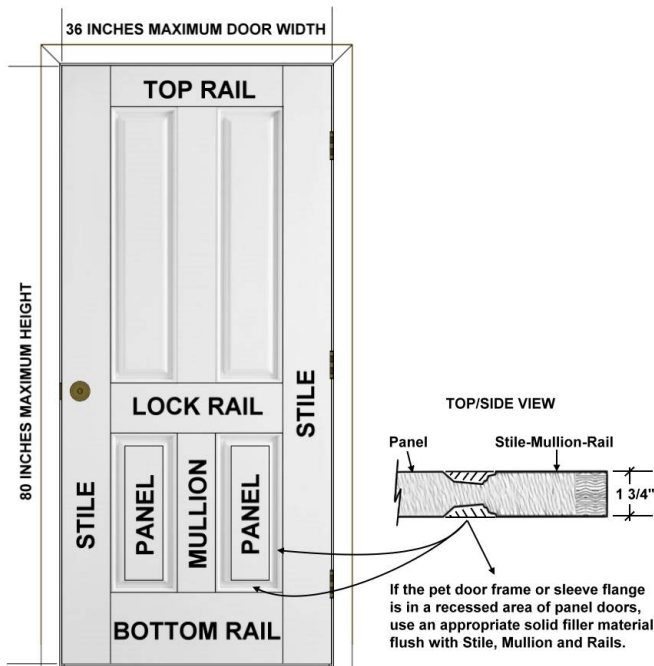

Panel Fire Rated Door

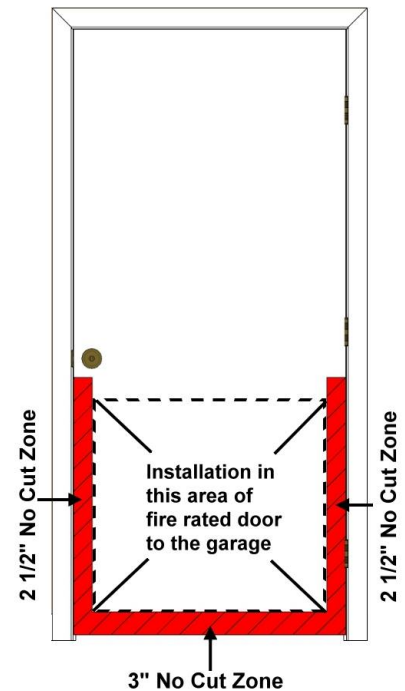

Flat Fire Rated Door

IMPORTANT

Check your existing door to the garage for the following before ordering:

1. 20 minute fire rated label
2. 36" wide x 80" high maximum dimensions
3. 1 3/4" inch thickness
4. Wood or Composite Core Door
5. Not Metal Doors
6. If your not sure - Check with a Professional



NOTE

What is a fire rated composite door?

A composite door is made using a range of materials, but generally consists of an outer veneer, this may be wood or other man-made materials. The door core is a mix of natural or man-made materials that gives it a fire rating.

CAUTION

If you are unable to determine if your door is the correct type, we highly recommend to replace your door with a certified 20 minute fire rated composite or wood door.

If you are not sure contact a professional to determine your fire door type.

It is **recommended** that you hire a handyman, carpenter, contractor or professional installer. However FireSafe Pets Pet Doors can be installed by anyone with good Do It Yourself and carpentry abilities.

STEP 1

Measure your Pet & mark door

- ① From your interior floor measure to your pets shoulders. Add 1-2 inches. This will be the top of the cut out for your pet door opening.
- ② Locate the opening on the door.
Note Minimum of 3" inches up from bottom of door & 2 1/2" inches from hinge edge of door.
- ③ Remove door by removing hinge pins.

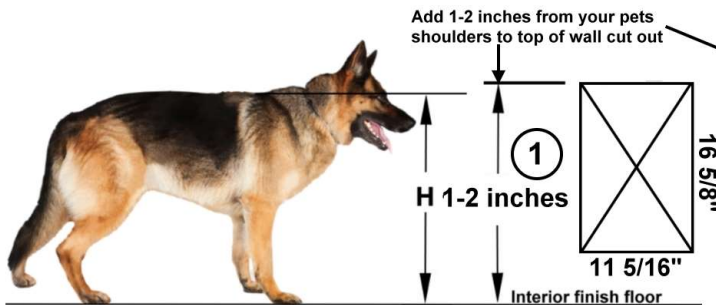

Remember to allow for pet growth

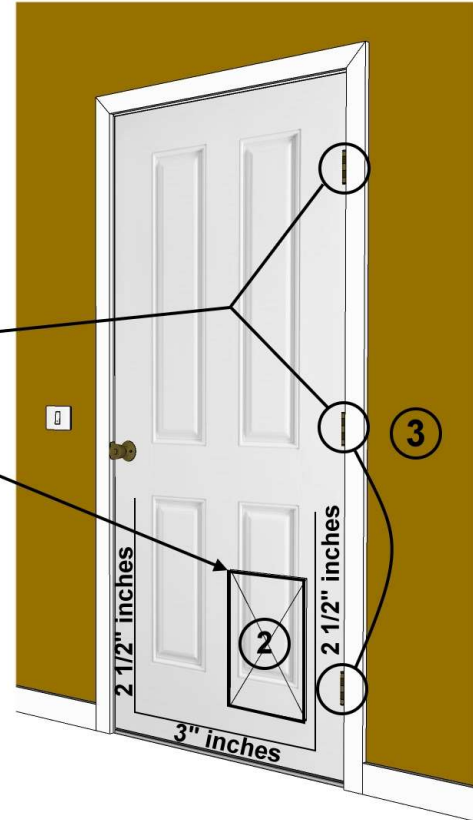

Interior door to garage

STEP 2

Locate pet door opening on door to garage

- ① Mark opening on door (11 5/16" wide x 16 5/8" tall).
- ② If your door has raised panels - center the door in panel or at center of door.
- ③ If flat panel door - cut opening anywhere between 2 1/2" from hinge edge or 3" inches from door bottom.

Door panel dimensions vary from manufacturer. Adjust center of opening to center of panel as necessary.

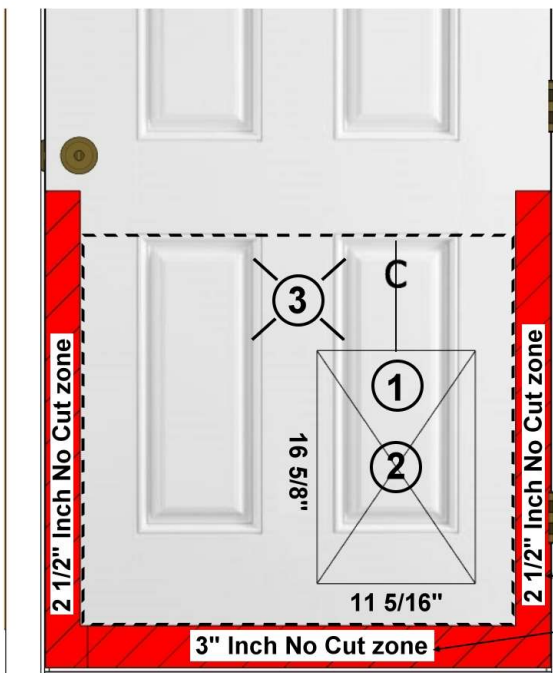

Interior side of door to garage

⚠ NOTE DO NOT cut opening within 3" inches of the bottom or 2 1/2" from hinge side of doors .

STEP 3

From interior side of door cut out opening

NOTE We recommend removing the door from the frame and set up horizontally on sawhorses for more precise and ease of cutout.

The method to cut out and installation will vary from installer. The Pet Door can be installed with the door hanging based on skill level of the installer.

- ① Place on a raised level surface such as saw horses. Place interior side of door facing up with your pet door location marks.
- ② Using a skillsaw with a appropriate cutting blade cut out opening.
- ③ Trim the corners with a saber saw with appropriate cutting blade (3 1/2" long blade is recommended).

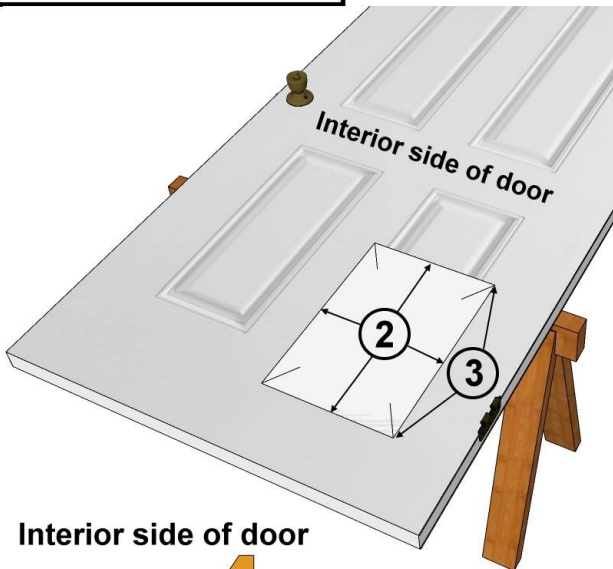
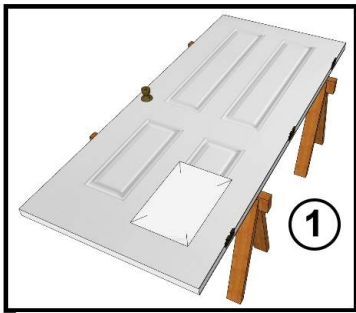

Interior side of door

STEP 4

From garage side of door- insert frame



Check the frame extension for fit & square. It is recommended to slide the garage side pet door frame into opening to ensure clearances and fit.

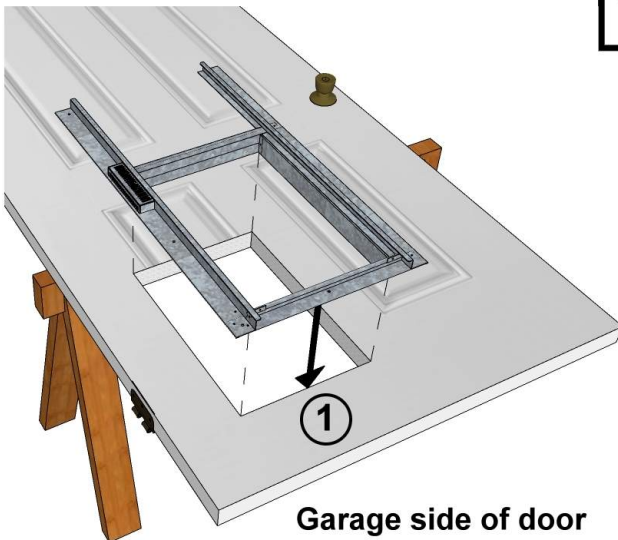

Garage side of door

- ① From the garage side - slide the pet door frame into the new opening so the frame extension rests on bottom of the door cutout opening & is centered from side to side.

STEP 5

Mark screw hole locations

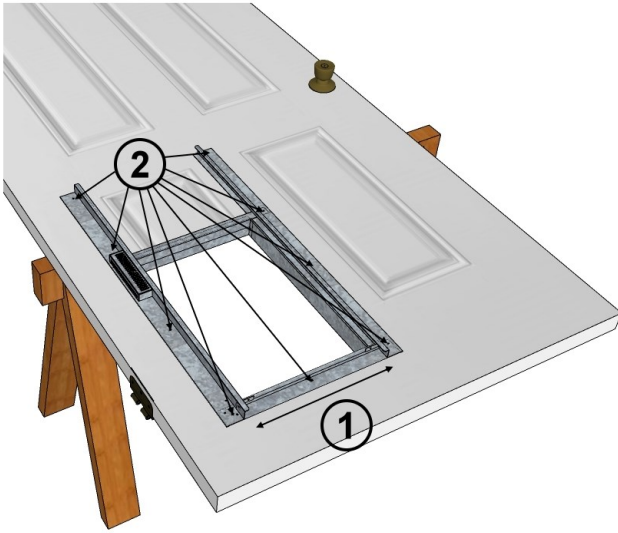

- ① With pet door frame resting on bottom of cut out opening & center from side to side.
- ② Mark screw installation hole locations on the door.

STEP 6

Remove frame & drill holes in fire door

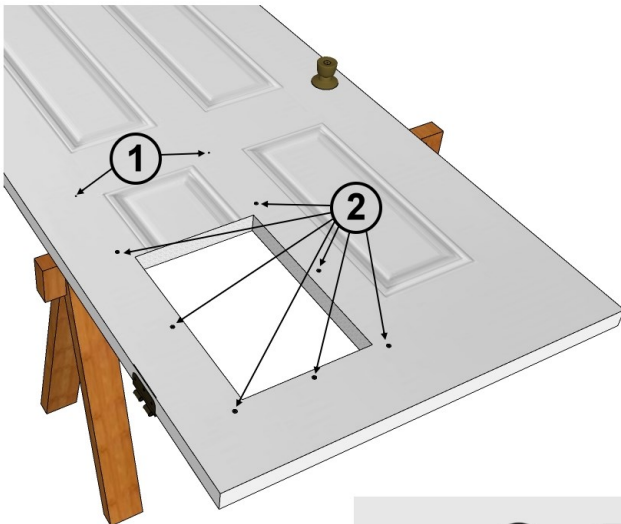

- ① Drill (2) 7/64" holes - 3/4" deep holes in door. Carefull not to drill trough door.
- ② Drill (7) 15/64" holes through door. Ensure drill is square to door at 90° to line up holes to interior flap frame holes.

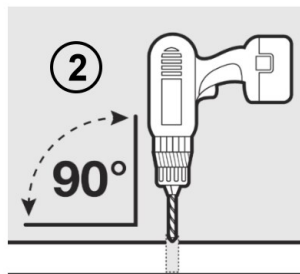

STEP 7

Insert garage side frame & line up holes

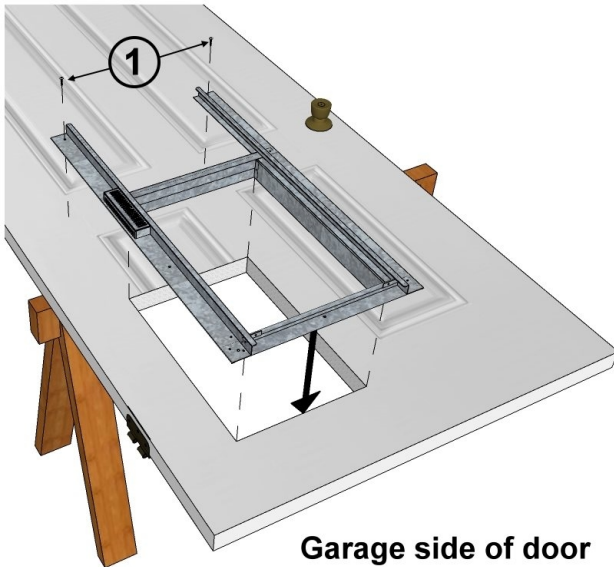

- ① With the pet door frame inserted in the opening, install (2) top screws loosely to hold the pet door frame in place.

STEP 8

Interior flap frame ready for installation

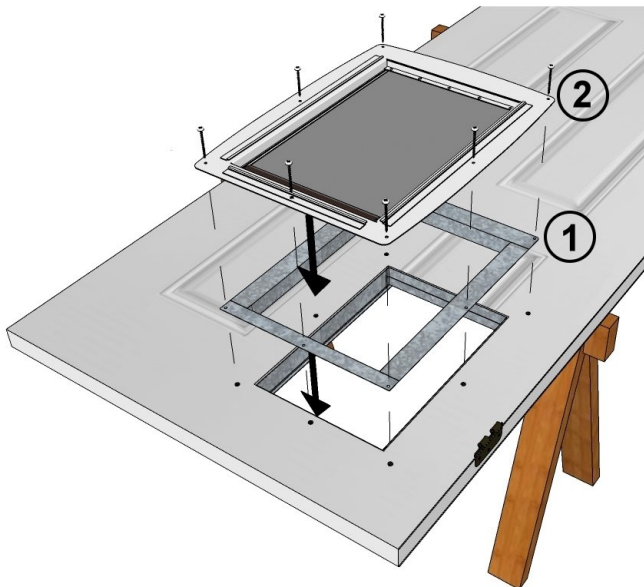

From the interior side - Install flap frame

- ① Slide in the sleeve into the garage side door extension.
- ② Install flap frame using #8 machine screws through the garage side pet door frame.

Interior side of door

STEP 9

Install machine screws to garage side frame

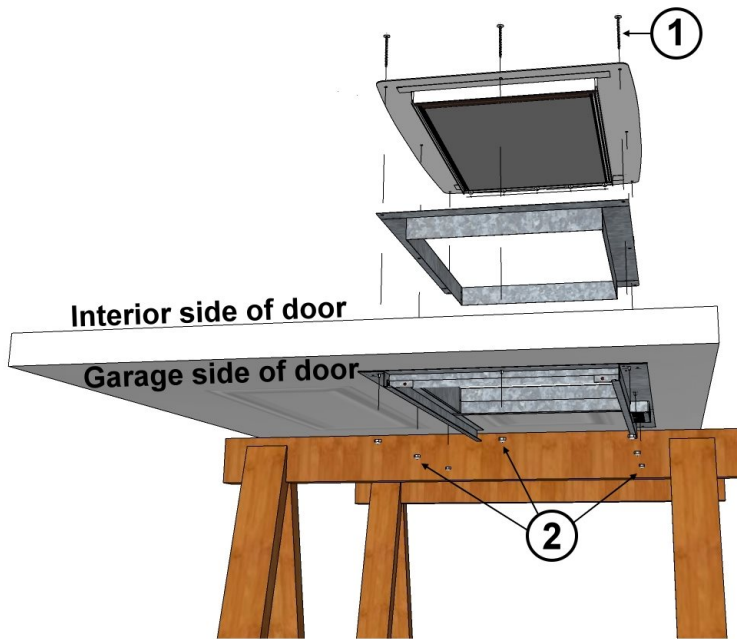

① From the interior flap frame side - Install #8 machine screws through to garage side of pet door frame.

② Snugly tighten screws & nuts.

Note* Door thicknesses may vary. Use supplied washers on garage side of frame if necessary. (not shown)

Interior side of door

STEP 10

Re-hang door to garage



Check the interior flap frame for fit. Flap frame should rest on bottom on garage side door frame extension. Make sure the pet door frame is square to the door.

② Check the interior flap frame for fit. Flap frame should rest on bottom on garage side door frame extension and be centered side to side of opening.

STEP 11

Slide door into garage frame channels



- ① Check alignment in opening and center from side to side and all screws are snugly tightened.
- ② Slide door from the top into the garage side frame channels. The door will rest on the release rod.

STEP 12

Final fit & function check



Do a final check for square, level & plumb of pet door. Check side to side for even space before final tightening all screws and nuts.

- ① Installation is complete. Always be sure to double check the screws & nuts are tight.

DO NOT over tighten installation screws. It may warp frame.

Note* Door will have a small amount of play in the frame channels.